

# Paddington 23



House (width x length)  
**12.85m x 19.95m**

Minimum Lot Width#  
**14m+**

Minimum Lot Depth#  
**25m+**

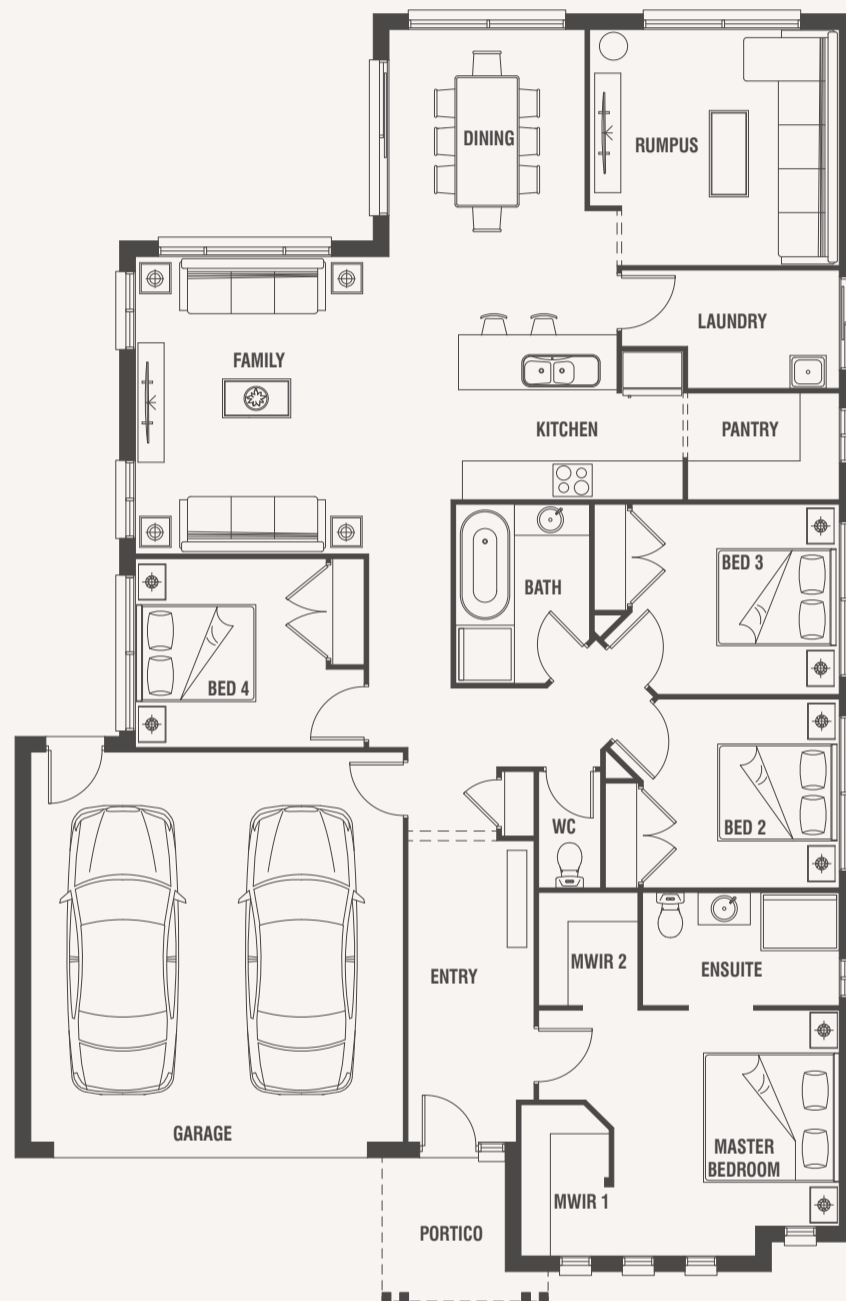

Standard floorplan with Riviera façade

## Design Options

- + Bedroom 3 Plus Alfresco
- + Ensuite

For a more detailed view of all floorplans, visit [porterdavis.com.au](http://porterdavis.com.au)

## Room Sizes

Master Bedroom	3.5 x 3.8m
Bedroom 2	3.0 x 2.9m
Bedroom 3	3.2 x 2.9m
Bedroom 4	2.9 x 2.9m
Family	3.6 x 4.7m
Dining	3.0 x 3.5m
Rumpus	3.8 x 3.7m

## Specifications

Ground Floor	167.54m <sup>2</sup>	18.03sq
Garage	37.63m <sup>2</sup>	4.05sq
Porch	4.49m <sup>2</sup>	0.48sq*
<b>Total</b>	<b>209.66m<sup>2</sup></b>	<b>22.57sq*</b>

# PORTER DAVIS HOMES