

# Paddington 22



House (width x length)  
11.45m x 21.11m

Minimum Lot Width#  
12.5m+

Minimum Lot Depth#  
28m+

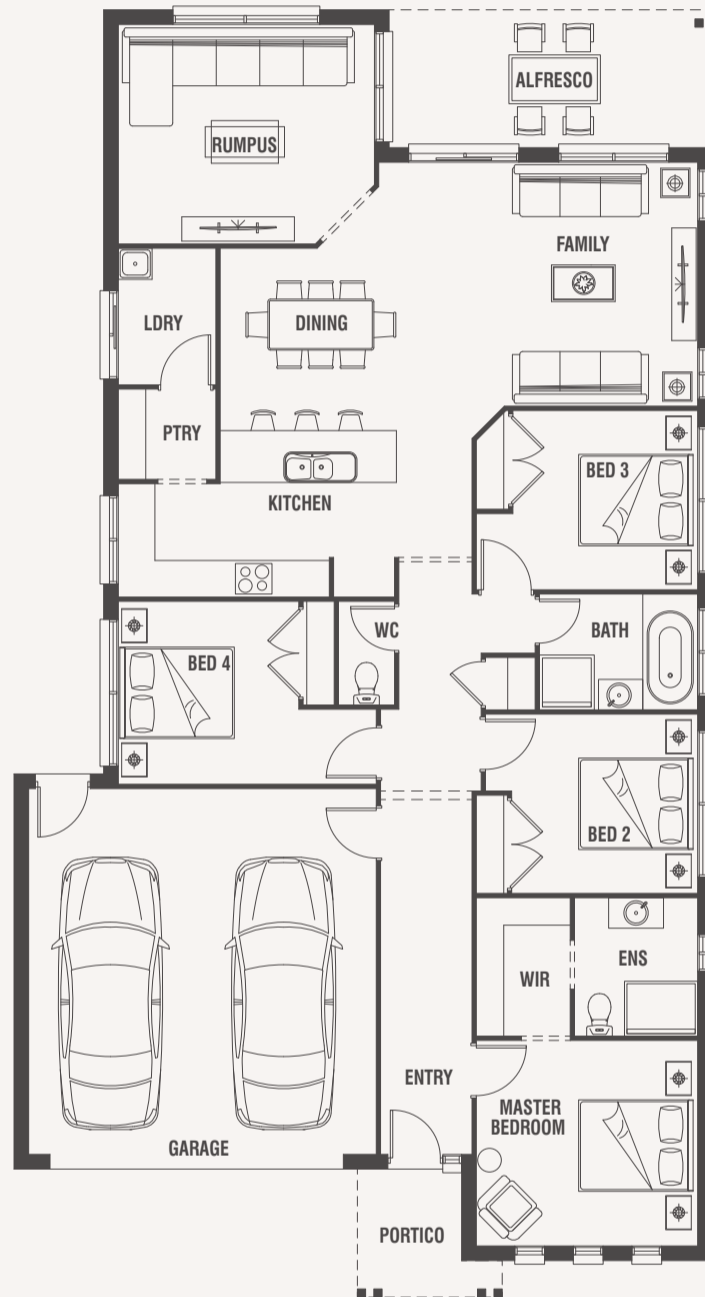

Standard floorplan with Riviera façade

## Design Options

- + Double Ensuite Vanity
- + Grand Alfresco
- + Grand Rumpus, Grand Family & Alfresco

For a more detailed view of all floorplans, visit [porterdavis.com.au](http://porterdavis.com.au)

## Room Sizes

Master Bedroom	3.6 x 3.4m
Bedroom 2	3.1 x 2.9m
Bedroom 3	3.0 x 2.9m
Bedroom 4	3.0 x 3.0m
Family	3.7 x 4.0m
Dining	4.1 x 3.0m
Rumpus	4.2 x 3.6m

## Specifications

Living Area	156.01m <sup>2</sup>	16.79sq
Garage	37.42m <sup>2</sup>	4.03sq
Portico	3.99m <sup>2</sup>	0.43sq
Alfresco	10.87m <sup>2</sup>	1.17sq*
<b>Total</b>	<b>208.29m<sup>2</sup></b>	<b>22.42sq*</b>

# PORTER DAVIS HOMES